

© OPEN STREETMAP (AND) CONTRIBUTORS, CC-BY-SA

**MAINTENANCE DREDGING  
AT  
CHURCH CREEK  
ANNE ARUNDEL COUNTY**

24-WL-0054  
202460070  
8/7/2024  
Sheet 1 of 18

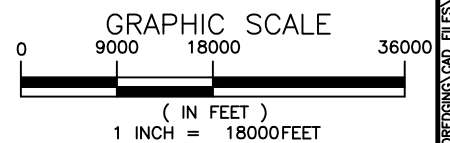

APPL. BY: ANNE ARUNDEL COUNTY DEPARTMENT OF PUBLIC WORKS

**VICINITY MAP**

DATE: JANUARY 2024 SHEET 1 OF 10

**Bayland**  
Consultants & Designers, Inc.  
*"Integrating Engineering and Environment"*

7455 New Ridge Road, Suite 1 Phone: (410) 694-9401  
Hanover, Maryland 21076 Fax: (410) 694-9405  
www.baylandinc.com

Z:\5\_4903\_CHURCH\_CREEK\_DREDGING\CAD FILES\SHEET FILES\JPA\5\_4903\_JPA01.DWG

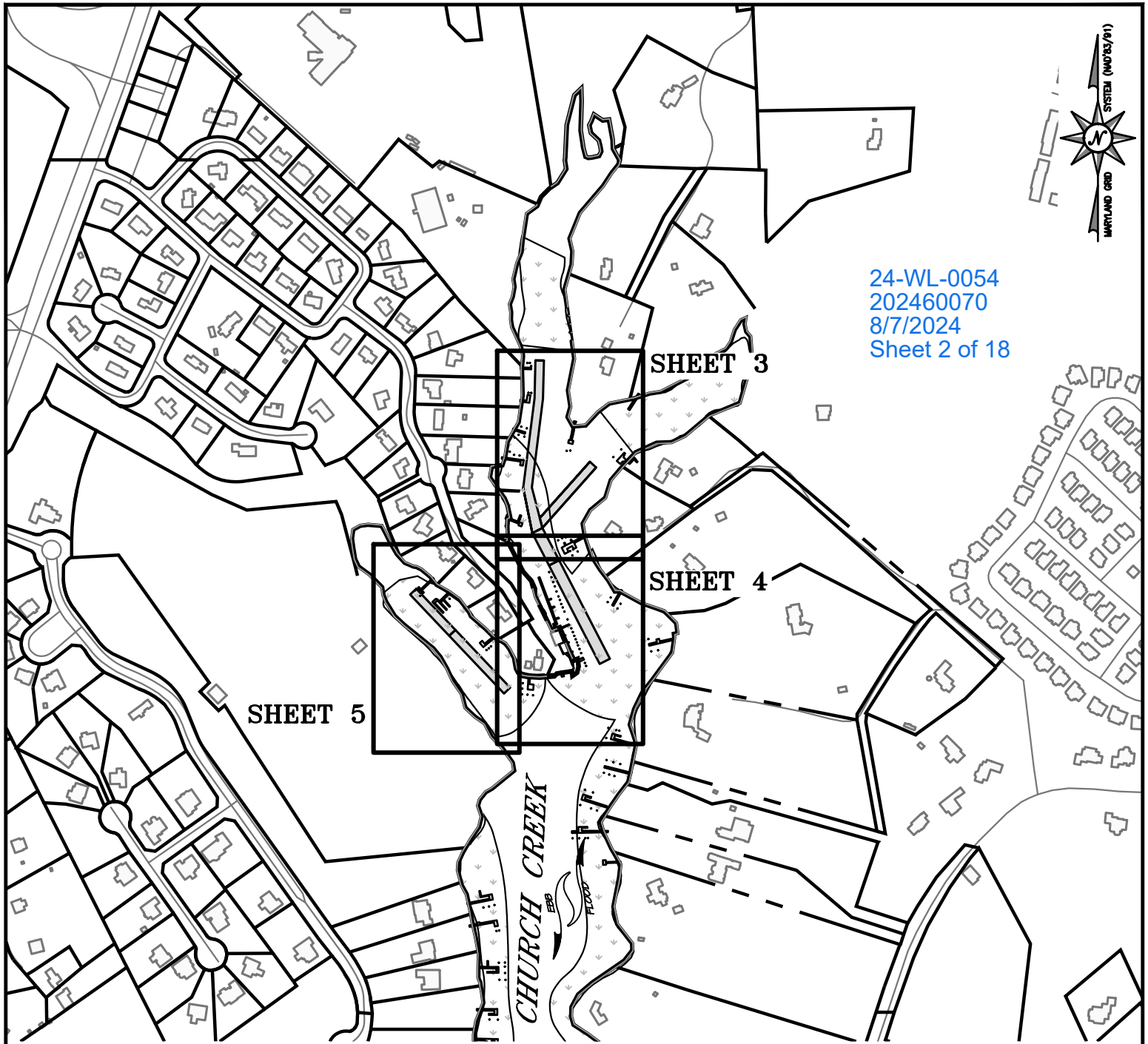

MAINTENANCE DREDGING  
 AT  
 CHURCH CREEK  
 ANNE ARUNDEL COUNTY

APPL. BY: ANNE ARUNDEL COUNTY DEPARTMENT OF PUBLIC WORKS

KEY SHEET

DATE: JANUARY 2024 SHEET 2 OF 10

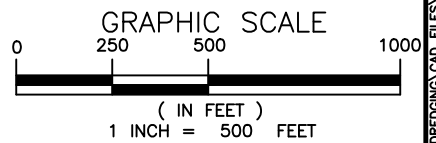

**Bayland**  
 Consultants & Designers, Inc.  
*"Integrating Engineering and Environment"*  
 7455 New Ridge Road, Suite 1 Phone: (410) 694-9401  
 Hanover, Maryland 21076 Fax: (410) 694-9405  
 www.baylandinc.com

Z:\5\_4903\_CHURCH\_CREEK\_DREDGING\CAD FILES\SHEET FILES\PA 5\_4903\_JPA02.DWG

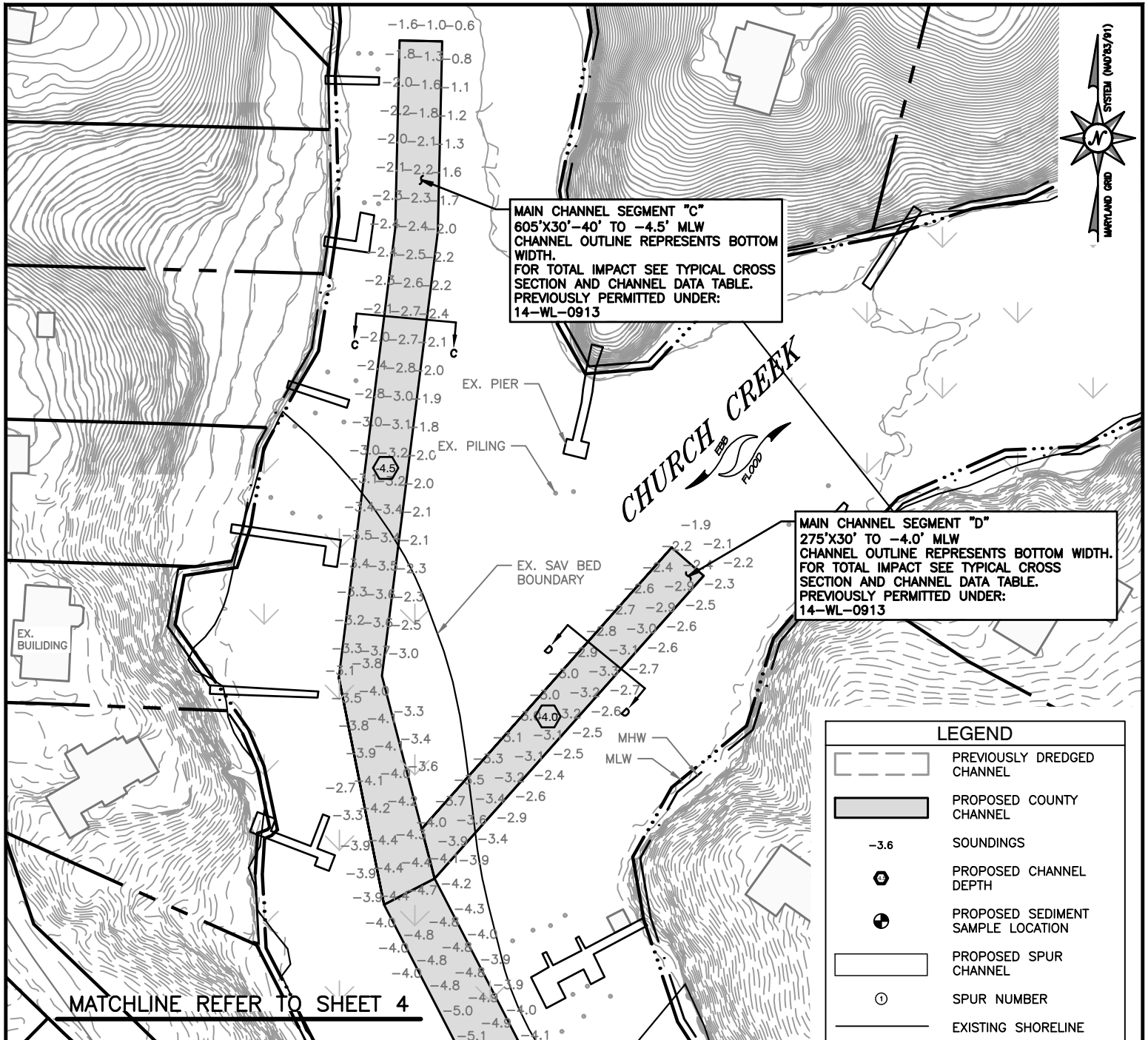

**MAIN CHANNEL SEGMENT "C"**  
 605'X30'-40' TO -4.5' MLW  
 CHANNEL OUTLINE REPRESENTS BOTTOM WIDTH.  
 FOR TOTAL IMPACT SEE TYPICAL CROSS SECTION AND CHANNEL DATA TABLE.  
 PREVIOUSLY PERMITTED UNDER:  
 14-WL-0913

**MAIN CHANNEL SEGMENT "D"**  
 275'X30' TO -4.0' MLW  
 CHANNEL OUTLINE REPRESENTS BOTTOM WIDTH.  
 FOR TOTAL IMPACT SEE TYPICAL CROSS SECTION AND CHANNEL DATA TABLE.  
 PREVIOUSLY PERMITTED UNDER:  
 14-WL-0913

LEGEND	
	PREVIOUSLY DREDGED CHANNEL
	PROPOSED COUNTY CHANNEL
-3.6	SOUNDINGS
	PROPOSED CHANNEL DEPTH
	PROPOSED SEDIMENT SAMPLE LOCATION
	PROPOSED SPUR CHANNEL
	SPUR NUMBER
	EXISTING SHORELINE
	APPROX. PROPERTY LINES
	EXISTING BOAT LIFT
	EXISTING PILING
	APPROX MHW
	APPROX MLW

SAV LEGEND	
	COMPOSITE SAV BED FROM SPRING AND SUMMER SAV SURVEY 2023
SPRING SURVEY DATE: MAY 10, 2023	
SUMMER SURVEY DATE: JULY 20, 2023	

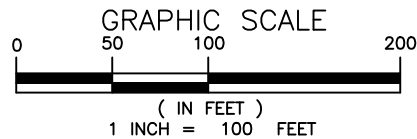

MATCHLINE REFER TO SHEET 4

24-WL-0054  
 202460070  
 8/7/2024  
 Sheet 3 of 18

**MAINTENANCE DREDGING  
 AT  
 CHURCH CREEK  
 ANNE ARUNDEL COUNTY**

APPL. BY: ANNE ARUNDEL COUNTY DEPARTMENT OF PUBLIC WORKS

**MAIN CHANNEL PLAN**

DATE: JANUARY 2024 SHEET 3 OF 10

**Bayland**  
 Consultants & Designers, Inc.  
 "Integrating Engineering and Environment"

7455 New Ridge Road, Suite 1 Phone: (410) 694-9401  
 Hanover, Maryland 21076 Fax: (410) 694-9405  
 www.baylandinc.com

Z:\5\_4903\_CHURCH\_CREEK\_DREDGING\CAD FILES\SHEET FILES\PA 5\_4903\_JPA03.DWG

MATCHLINE REFER TO SHEET 3

MAIN CHANNEL SEGMENT "B"  
130'X40' TO -5.5' MLW  
CHANNEL OUTLINE REPRESENTS BOTTOM  
WIDTH.  
FOR TOTAL IMPACT SEE TYPICAL CROSS  
SECTION AND CHANNEL DATA TABLE.  
PREVIOUSLY PERMITTED UNDER:  
14-WL-0913

MAIN CHANNEL SEGMENT "A"  
390'X40' TO -6.5' MLW  
CHANNEL OUTLINE REPRESENTS BOTTOM  
WIDTH.  
FOR TOTAL IMPACT SEE TYPICAL CROSS  
SECTION AND CHANNEL DATA TABLE.  
PREVIOUSLY PERMITTED UNDER:  
14-WL-0913

MAIN CHANNEL SEGMENT "E"  
280'X30' TO -5.5' MLW  
CHANNEL OUTLINE REPRESENTS BOTTOM  
WIDTH.  
FOR TOTAL IMPACT SEE TYPICAL CROSS  
SECTION AND CHANNEL DATA TABLE.  
PREVIOUSLY PERMITTED UNDER:  
14-WL-0913



MATCHLINE REFER TO SHEET 5

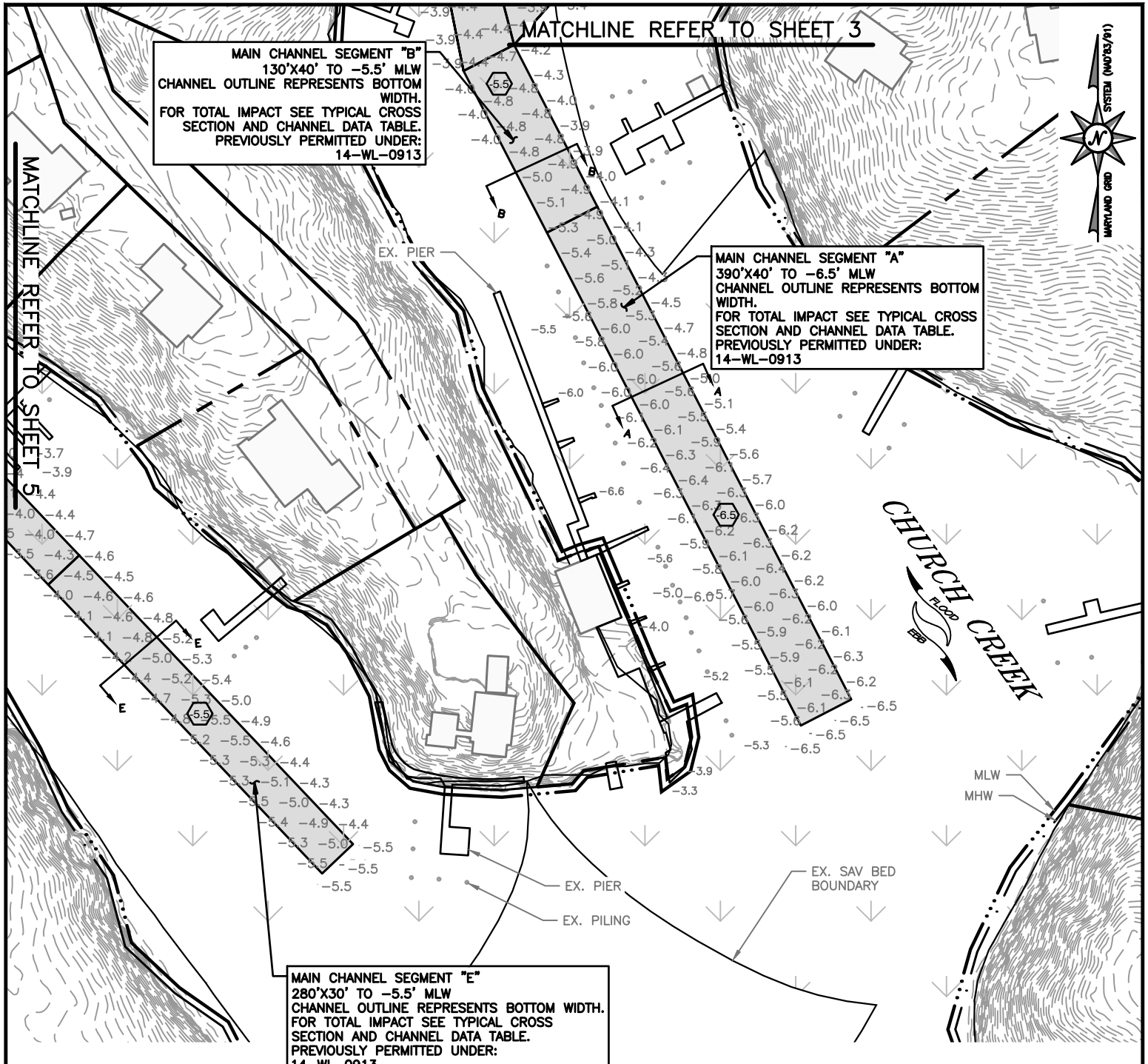

24-WL-0054  
202460070  
8/7/2024  
Sheet 4 of 18

MAINTENANCE DREDGING  
AT  
CHURCH CREEK  
ANNE ARUNDEL COUNTY

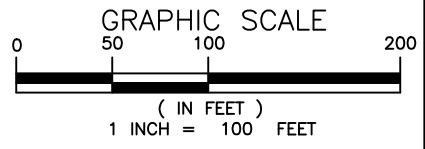

APPL. BY: ANNE ARUNDEL COUNTY DEPARTMENT OF PUBLIC WORKS

MAIN CHANNEL PLAN

DATE: JANUARY 2024 SHEET 4 OF 10

Consultants & Designers, Inc.  
"Integrating Engineering and Environment"  
7455 New Ridge Road, Suite 1 Phone: (410) 694-9401  
Hanover, Maryland 21076 Fax: (410) 694-9405  
www.baylandinc.com

Z:\5\_4903\_CHURCH\_CREEK\_DREDGING\CAD FILES\SHEET FILES\IPA 5\_4903\_IPA04.DWG

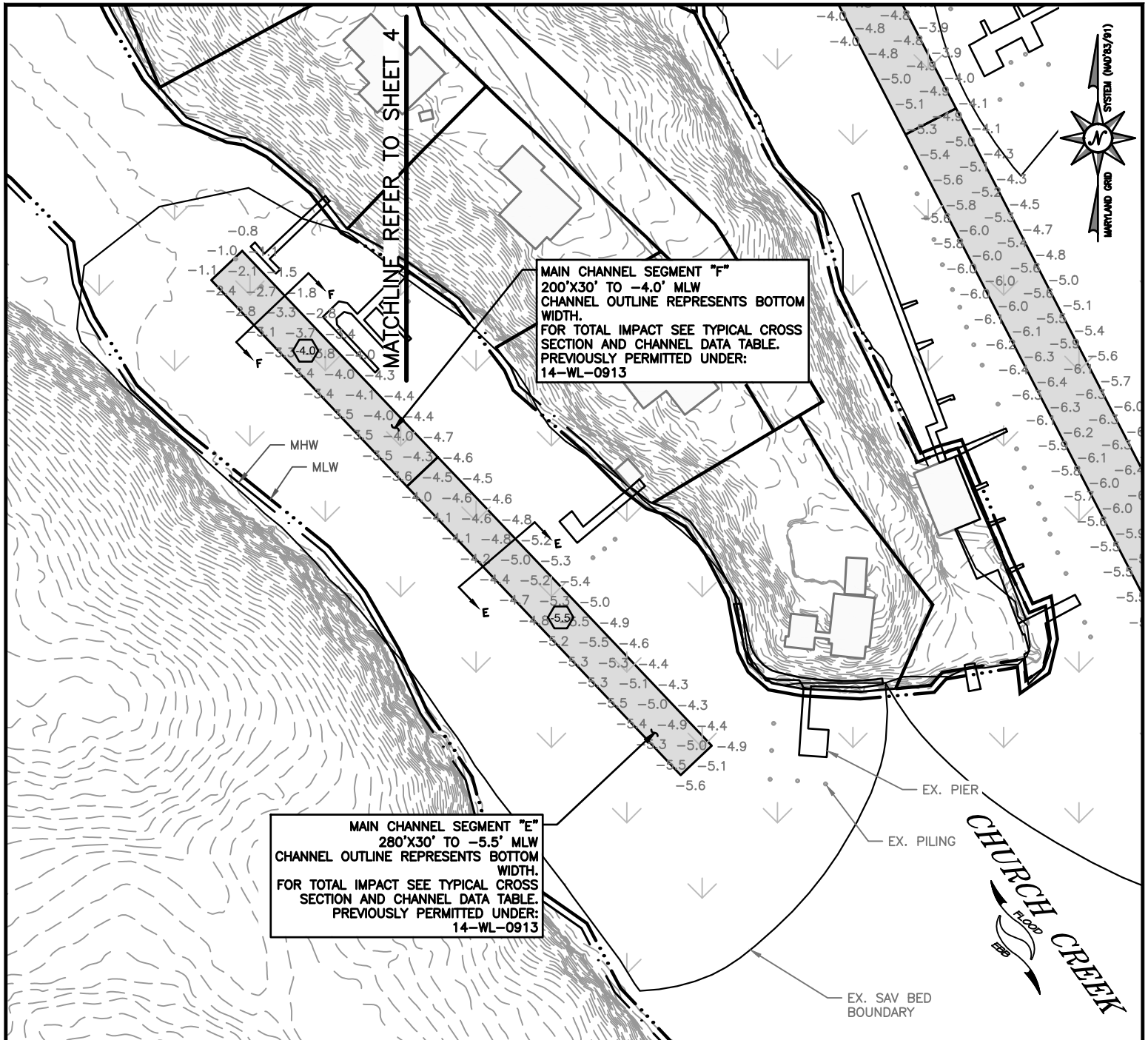

**MAIN CHANNEL SEGMENT "F"**  
 200'X30' TO -4.0' MLW  
 CHANNEL OUTLINE REPRESENTS BOTTOM  
 WIDTH.  
 FOR TOTAL IMPACT SEE TYPICAL CROSS  
 SECTION AND CHANNEL DATA TABLE.  
 PREVIOUSLY PERMITTED UNDER:  
 14-WL-0913

**MAIN CHANNEL SEGMENT "E"**  
 280'X30' TO -5.5' MLW  
 CHANNEL OUTLINE REPRESENTS BOTTOM  
 WIDTH.  
 FOR TOTAL IMPACT SEE TYPICAL CROSS  
 SECTION AND CHANNEL DATA TABLE.  
 PREVIOUSLY PERMITTED UNDER:  
 14-WL-0913

24-WL-0054  
 202460070  
 8/7/2024  
 Sheet 5 of 18

**MAINTENANCE DREDGING  
 AT  
 CHURCH CREEK  
 ANNE ARUNDEL COUNTY**

APPL. BY: ANNE ARUNDEL COUNTY DEPARTMENT OF PUBLIC WORKS

**MAIN CHANNEL PLAN**

DATE: JANUARY 2024 SHEET 5 OF 10

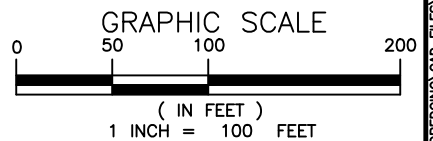

**Bayland**  
 Consultants & Designers, Inc.  
*"Integrating Engineering and Environment"*  
 7455 New Ridge Road, Suite 1 Phone: (410) 694-9401  
 Hanover, Maryland 21076 Fax: (410) 694-9405  
 www.baylandinc.com

Z:\5\_4903\_CHURCH\_CREEK\_DREDGING\CAD FILES\SHEET FILES\IPA\5\_4903\_IPA05.DWG

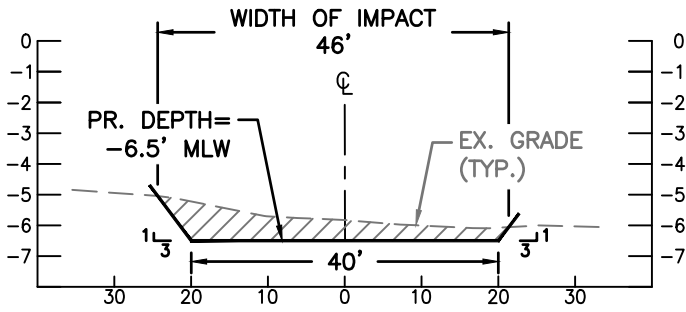

## SECTION A-A

SCALE: NTS

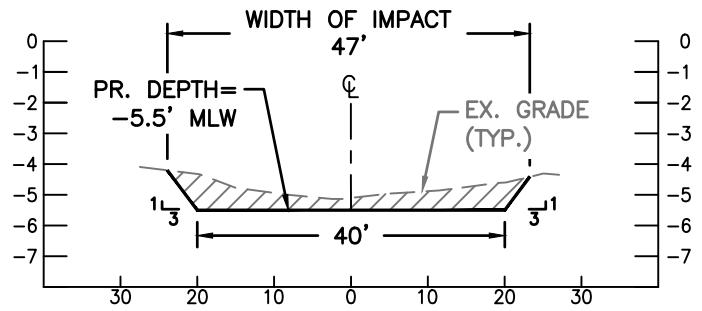

## SECTION B-B

SCALE: NTS

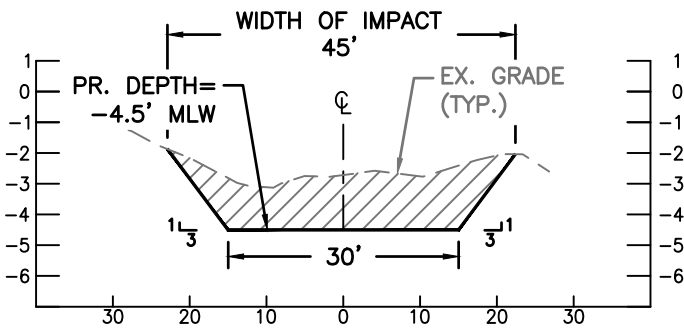

## SECTION C-C

SCALE: NTS

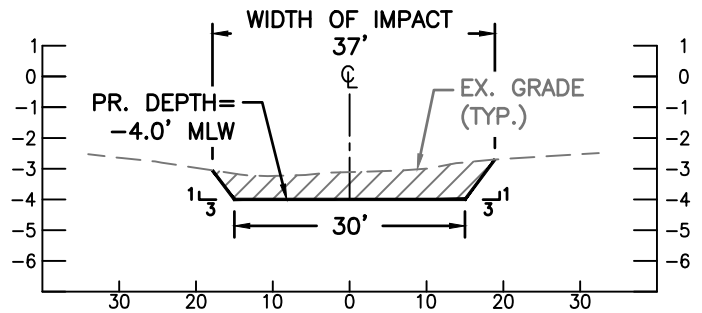

## SECTION D-D

SCALE: NTS

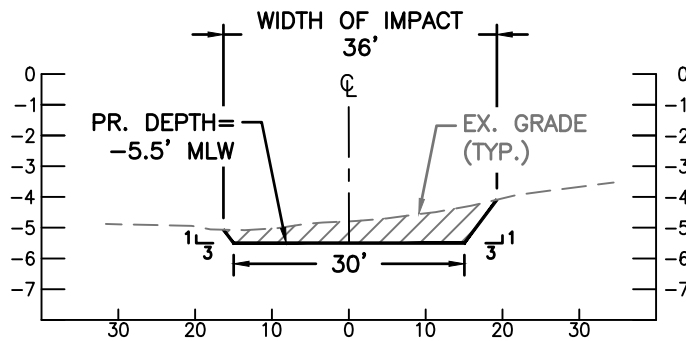

## SECTION E-E

SCALE: NTS

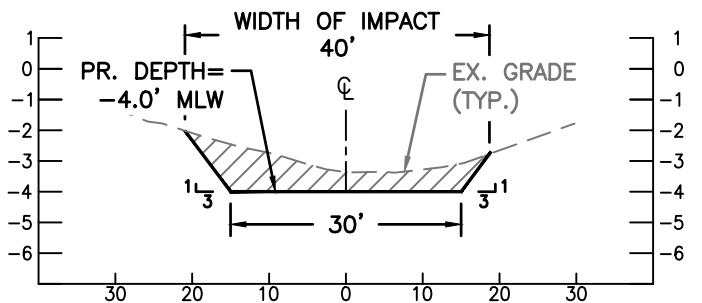

## SECTION F-F

SCALE: NTS

MAINTENANCE DREDGING  
AT  
CHURCH CREEK  
ANNE ARUNDEL COUNTY

24-WL-0054  
202460070  
8/7/2024  
Sheet 6 of 18

APPL. BY: ANNE ARUNDEL COUNTY DEPARTMENT OF PUBLIC WORKS

CHANNEL SECTIONS

DATE: JANUARY 2024 SHEET 6 OF 10

## CHANNEL DETAILS

SEGMENT	LENGTH (FT)	WIDTH (FT)	DEPTH (FT)	VOLUME (CY)
A	390	40	-6.5	383
B	130	40	-5.5	140
C	605	30-40	-4.5	1202
D	275	30	-4.0	294
E	280	30	-5.5	173
F	200	30	-4.0	154
TOTAL MAIN CHANNEL LENGTH				1,880 LF
TOTAL MAIN CHANNEL VOLUME				2,346 CY
TOTAL MAIN CHANNEL AREA OF IMPACT				77,387 SF = 1.78 AC
TOTAL NEW AREA OF DREDGING				0 = 0.00 AC
TOTAL MAIN CHANNEL AREA OF IMPACT TO 2023 SAV				45,180 SF = 1.04 AC

**NOTES:**

1. BASEMAP COMPILED FROM ANNE ARUNDEL COUNTY 2020 PLANIMETRICS AND 2021 IMAGERY.
2. TIDAL RANGE IS 1.0 FEET.
3. BATHYMETRY FROM BAYLAND SURVEY DATED AUGUST 28, 2023.
4. SOUNDINGS ARE IN FEET AND REFER TO MLW.
5. THE CHURCH CREEK CHANNELS PROPOSED FOR MAINTENANCE DREDGING WERE PREVIOUSLY PERMITTED UNDER WL-14-0913(R); U.S. ARMY CORPS OF ENGINEERS PERMIT CENAB-OP-RMN 2014-61665-M18.
6. THESE ARE PERMIT DRAWINGS ONLY. DESIGN DRAWINGS WILL BE PREPARED SEPARATELY.

24-WL-0054  
 202460070  
 8/7/2024  
 Sheet 7 of 18

**MAINTENANCE DREDGING  
 AT  
 CHURCH CREEK  
 ANNE ARUNDEL COUNTY**

APPL. BY: ANNE ARUNDEL COUNTY DEPARTMENT OF PUBLIC WORKS

**CHANNEL SECTIONS**

DATE: JANUARY 2024 SHEET 7 OF 10



Z:\5\_4903\_CHURCH\_CREEK\_DREDGING\CAD FILES\SHEET FILES\5\_4903\_JPA07.DWG

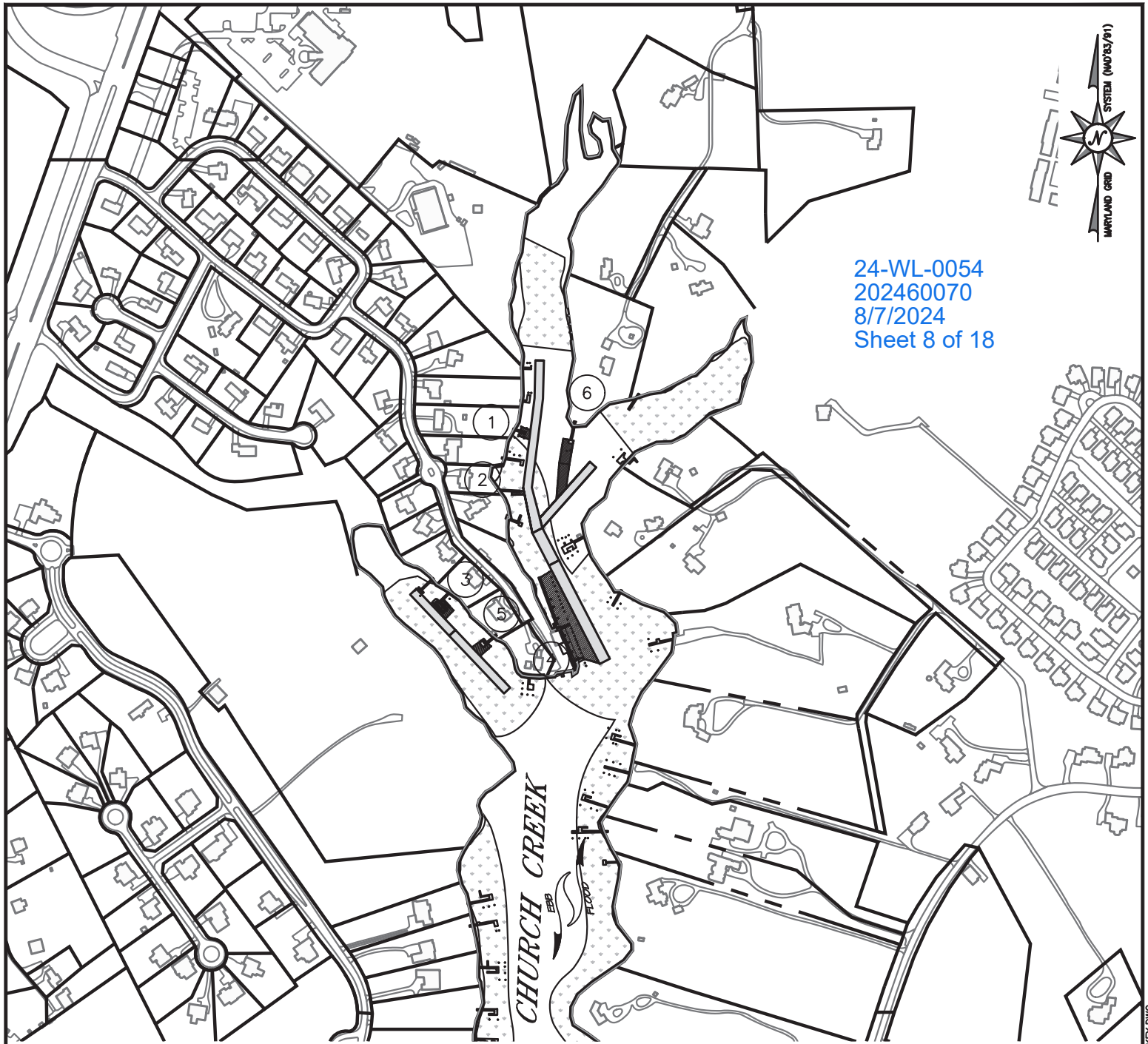

24-WL-0054  
 202460070  
 8/7/2024  
 Sheet 8 of 18

MAINTENANCE DREDGING  
 AT  
 CHURCH CREEK  
 ANNE ARUNDEL COUNTY

APPL. BY: ANNE ARUNDEL COUNTY DEPARTMENT OF PUBLIC WORKS

SPUR KEY SHEET

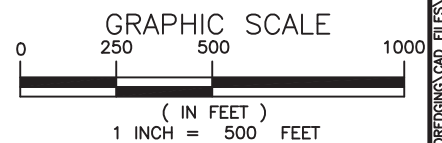

**Bayland**  
 Consultants & Designers, Inc.  
*"Integrating Engineering and Environment"*  
 7455 New Ridge Road, Suite 1 Phone: (410) 694-9401  
 Hanover, Maryland 21076 Fax: (410) 694-9405  
 www.baylandinc.com

Z:\5\_4903\_CHURCH\_CREEK\_DREDGING\CAD FILES\SHEET FILES\5\_4903\_SPUR\_KEY.DWG



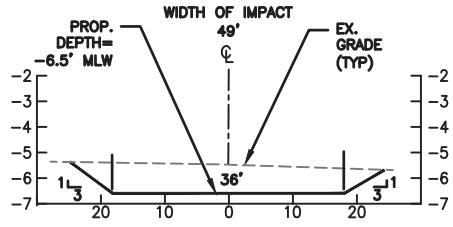

**TYPICAL SPUR DREDGING SECTION**  
SCALE: NTS

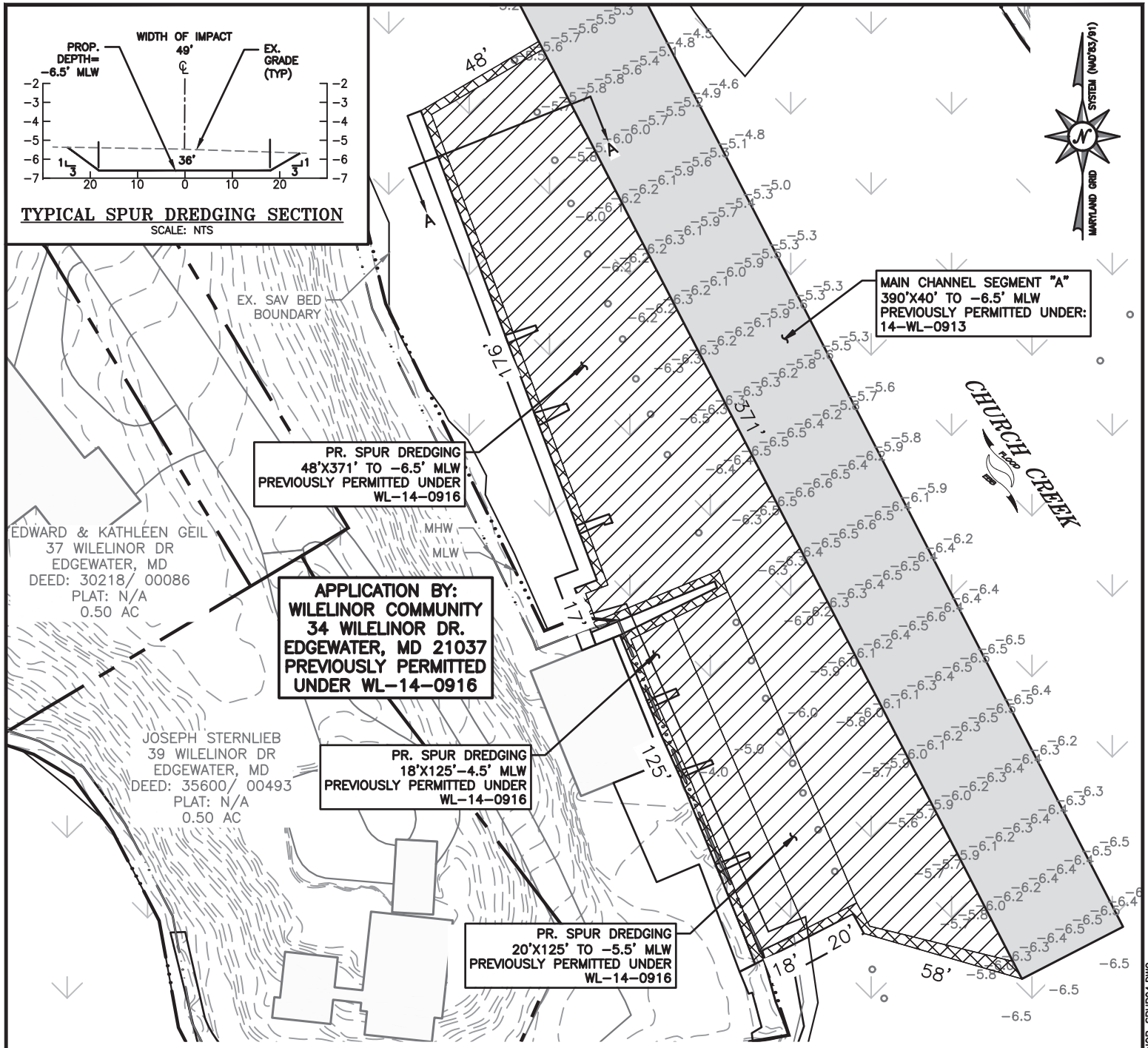

**MAIN CHANNEL SEGMENT "A"**  
390'X40' TO -6.5' MLW  
PREVIOUSLY PERMITTED UNDER:  
14-WL-0913

**PR. SPUR DREDGING**  
48'X371' TO -6.5' MLW  
PREVIOUSLY PERMITTED UNDER  
WL-14-0916

**APPLICATION BY:**  
WILELINOR COMMUNITY  
34 WILELINOR DR.  
EDGEWATER, MD 21037  
PREVIOUSLY PERMITTED  
UNDER WL-14-0916

**PR. SPUR DREDGING**  
18'X125'-4.5' MLW  
PREVIOUSLY PERMITTED UNDER  
WL-14-0916

**PR. SPUR DREDGING**  
20'X125' TO -5.5' MLW  
PREVIOUSLY PERMITTED UNDER  
WL-14-0916

EDWARD & KATHLEEN GEIL  
37 WILELINOR DR  
EDGEWATER, MD  
DEED: 30218/ 00086  
PLAT: N/A  
0.50 AC

JOSEPH STERNLIEB  
39 WILELINOR DR  
EDGEWATER, MD  
DEED: 35600/ 00493  
PLAT: N/A  
0.50 AC

**SPUR DATA**

AREA = 22,308 SF  
VOLUME = 598 CY  
2023 SAV IMPACT = 22,308 SF

**LEGEND**

- 1.0 EXISTING DEPTH
- EXISTING PILING
- PROPOSED PILING

**SAV LEGEND**

COMPOSITE SAV BED FROM SPRING AND SUMMER SAV SURVEY 2023  
SPRING SURVEY DATE: MAY 10, 2023  
SUMMER SURVEY DATES: JULY 20, 2023

- BOTTOM CUT AREA
- SIDE SLOPE AREA

24-WL-0054  
202460070  
8/7/2024  
Sheet 9 of 18

Spur 4  
24-WL-0160  
Wilelinor Community

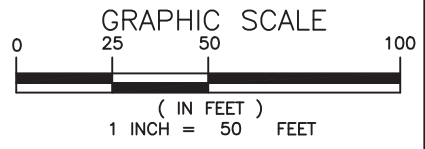

**NOTES:**

1. TIDAL RANGE IS 1.0 FEET.
2. SOUNDINGS ARE IN FEET AND REFER TO MLW.
3. MATERIAL WILL BE PLACED AT ROCK CREEK DMP SITE.
4. THESE ARE PERMIT DRAWINGS ONLY. DESIGN DRAWINGS WILL BE PREPARED SEPARATELY.
5. BASEMAP TAKEN FROM ANNE ARUNDEL COUNTY 2020 PLANIMETRICS AND 2020 IMAGERY.

**Consultants & Designers, Inc.**  
"Integrating Engineering and Environment"  
7455 New Ridge Road, Suite T Phone: (410) 694-9401  
Hanover, Maryland 21076 Fax: (410) 694-9405  
www.baylandinc.com

CHURCH CREEK SPURS  
SPUR 4  
WILELINOR COMMUNITY  
34 WILELINOR DRIVE  
EDGEWATER, MD 21037  
MARCH 2024

Z:\5\_4903\_CHURCH\_CREEK\_DREDGING\CAD FILES\SHEET FILES\SPURS\5\_4903\_WILELINOR\_SPUR04.DWG

FRANK & LINDA PITTELLI  
 33 WILELINOR DR  
 EDGEWATER, MD  
 DEED: 03974/ 00562  
 PLAT: N/A  
 0.54 AC

APPLICATION BY:  
**RAYMOND ROSENBERG**  
 35 WILELINOR DR.  
 EDGEWATER, MD 21037  
 PREVIOUSLY PERMITTED  
 UNDER WL-14-0914

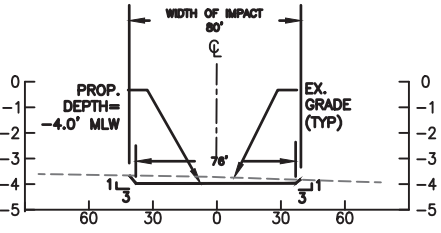

**TYPICAL SPUR DREDGING SECTION**  
 SCALE: NTS

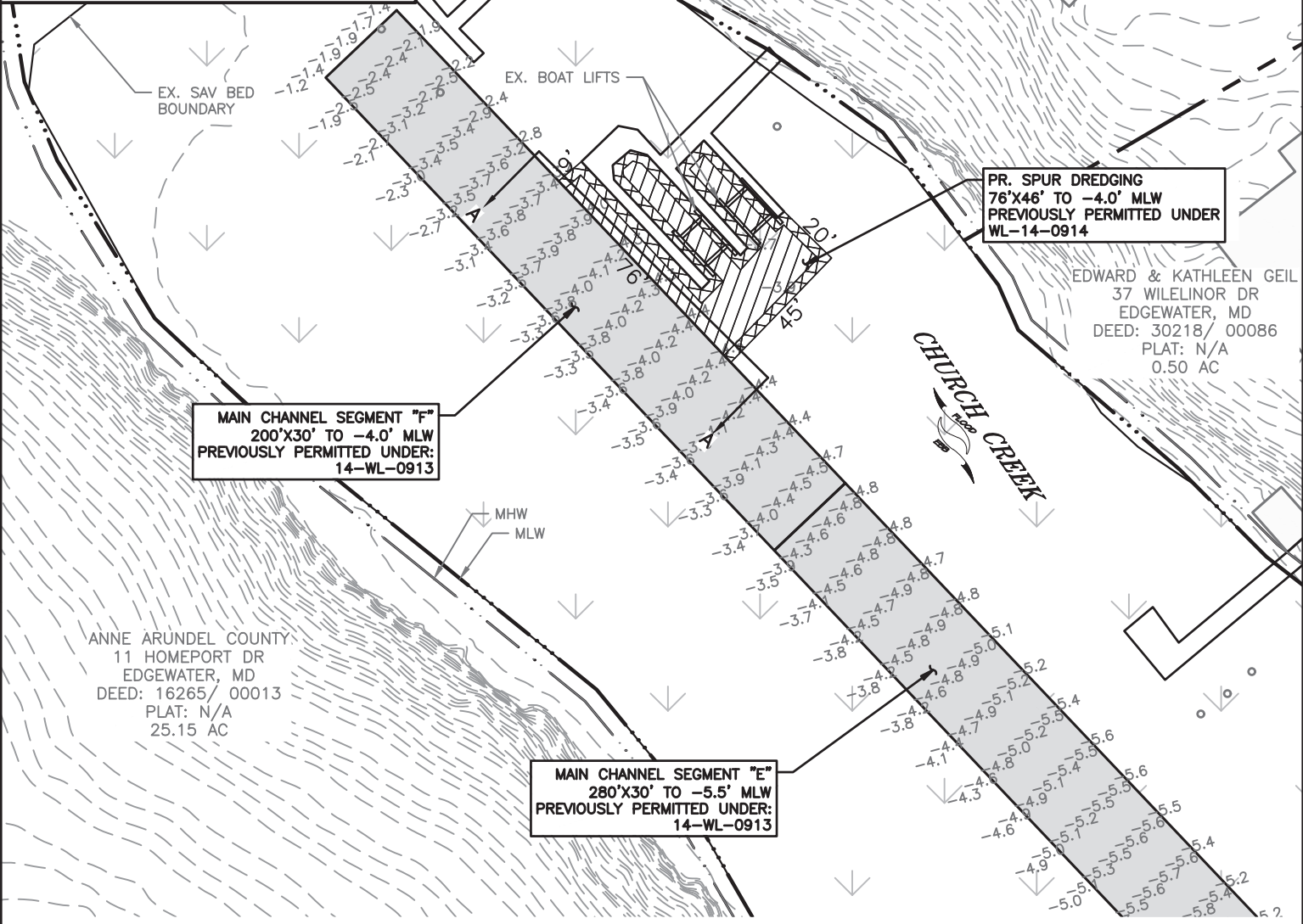

**MAIN CHANNEL SEGMENT "F"**  
 200'X30' TO -4.0' MLW  
 PREVIOUSLY PERMITTED UNDER:  
 14-WL-0913

**PR. SPUR DREDGING**  
 76'X46' TO -4.0' MLW  
 PREVIOUSLY PERMITTED UNDER  
 WL-14-0914

EDWARD & KATHLEEN GEIL  
 37 WILELINOR DR  
 EDGEWATER, MD  
 DEED: 30218/ 00086  
 PLAT: N/A  
 0.50 AC

ANNE ARUNDEL COUNTY  
 11 HOMEPORT DR  
 EDGEWATER, MD  
 DEED: 16265/ 00013  
 PLAT: N/A  
 25.15 AC

**MAIN CHANNEL SEGMENT "E"**  
 280'X30' TO -5.5' MLW  
 PREVIOUSLY PERMITTED UNDER:  
 14-WL-0913

**SPUR DATA**

AREA = 2,661 SF  
 VOLUME = 40 CY  
 2023 SAV IMPACT = 2,661 SF

**SAV LEGEND**

COMPOSITE SAV BED FROM SPRING AND SUMMER SAV SURVEY 2023  
 SPRING SURVEY DATE: MAY 10, 2023  
 SUMMER SURVEY DATES: JULY 20, 2023

**LEGEND**

- 1.0 EXISTING DEPTH
- EXISTING PILING
- PROPOSED PILING
- BOTTOM CUT AREA
- SIDE SLOPE AREA

**NOTES:**

1. TIDAL RANGE IS 1.0 FEET.
2. SOUNDINGS ARE IN FEET AND REFER TO MLW.
3. MATERIAL WILL BE PLACED AT ROCK CREEK DMP SITE.
4. THESE ARE PERMIT DRAWINGS ONLY. DESIGN DRAWINGS WILL BE PREPARED SEPARATELY.
5. BASEMAP TAKEN FROM ANNE ARUNDEL COUNTY 2020 PLANIMETRICS AND 2020 IMAGERY.

Spur 3  
 24-WL-0161  
 Rosenberg

24-WL-0054  
 202460070  
 8/7/2024  
 Sheet 10 of 18

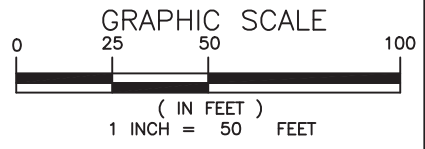

**Consultants & Designers, Inc.**  
*"Integrating Engineering and Environment"*  
 7455 New Ridge Road, Suite T Phone: (410) 694-9401  
 Hanover, Maryland 21076 Fax: (410) 694-9405  
 www.baylandinc.com

CHURCH CREEK SPURS  
 SPUR 3  
 RAYMOND ROSENBERG  
 35 WILELINOR DRIVE  
 EDGEWATER, MD 21037  
 MARCH 2024

Z:\5\_4903\_CHURCH\_CREEK\_DREDGING\CAD FILES\SHEET FILES\SPURS\5\_4903\_ROSENBERG\_SPUR03.DWG

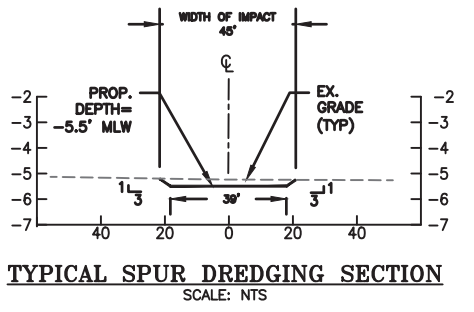

**APPLICATION BY:**  
KATHLEEN GEIL  
37 WILELINOR DR  
EDGEWATER, MD 21037  
PREVIOUSLY PERMITTED  
UNDER WL-14-0915



**MAIN CHANNEL SEGMENT "F"**  
200'X30' TO -4.0' MLW  
PREVIOUSLY PERMITTED UNDER:  
14-WL-0913

**PR. SPUR DREDGING TO -5.5' MLW**  
PREVIOUSLY PERMITTED UNDER  
WL-14-0915

JOSEPH STERNLIEB  
39 WILELINOR DR  
EDGEWATER, MD  
DEED: 35600/ 00493  
PLAT: N/A  
0.50 AC

ANNE ARUNDEL COUNTY  
11 HOMEPORT DR  
EDGEWATER, MD  
DEED: 16265/ 00013  
PLAT: N/A  
25.15 AC

**MAIN CHANNEL SEGMENT "E"**  
280'X30' TO -5.5' MLW  
PREVIOUSLY PERMITTED UNDER:  
14-WL-0913

**CHURCH CREEK**

**SPUR DATA**

AREA = 1,903 SF  
VOLUME = 33 CY  
2023 SAV IMPACT = 1,903 SF

SAV LEGEND	
	COMPOSITE SAV BED FROM SPRING AND SUMMER SAV SURVEY 2023
SPRING SURVEY DATE: MAY 10, 2023 SUMMER SURVEY DATES: JULY 20, 2023	

**Spur 5**  
**24-WL-0162**  
**Geil**

**LEGEND**

- 1.0 EXISTING DEPTH
- EXISTING PILING
- PROPOSED PILING
- BOTTOM CUT AREA
- SIDE SLOPE AREA

**24-WL-0054**  
**202460070**  
**8/7/2024**  
**Sheet 11 of 18**

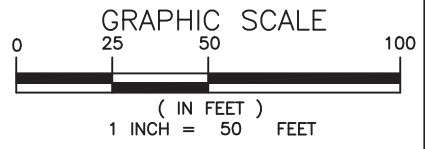

**NOTES:**

- TIDAL RANGE IS 1.0 FEET.
- SOUNDINGS ARE IN FEET AND REFER TO MLW.
- MATERIAL WILL BE PLACED AT ROCK CREEK DMP SITE.
- THESE ARE PERMIT DRAWINGS ONLY. DESIGN DRAWINGS WILL BE PREPARED SEPARATELY.
- BASEMAP TAKEN FROM ANNE ARUNDEL COUNTY 2020 PLANIMETRICS AND 2020 IMAGERY.

**Bayland**  
Consultants & Designers, Inc.  
"Integrating Engineering and Environment"  
7455 New Ridge Road, Suite T Phone: (410) 694-9401  
Hanover, Maryland 21076 Fax: (410) 694-9405  
www.baylandinc.com

CHURCH CREEK SPURS  
SPUR 5  
KATHLEEN GEIL  
37 WILELINOR DRIVE  
EDGEWATER, MD 21037  
MARCH 2024

Z:\5\_4903\_CHURCH\_CREEK\_DREDGING\CAD FILES\SHEET FILES\NPA\SPURS\5\_4903\_GEIL\_SPURS.DWG

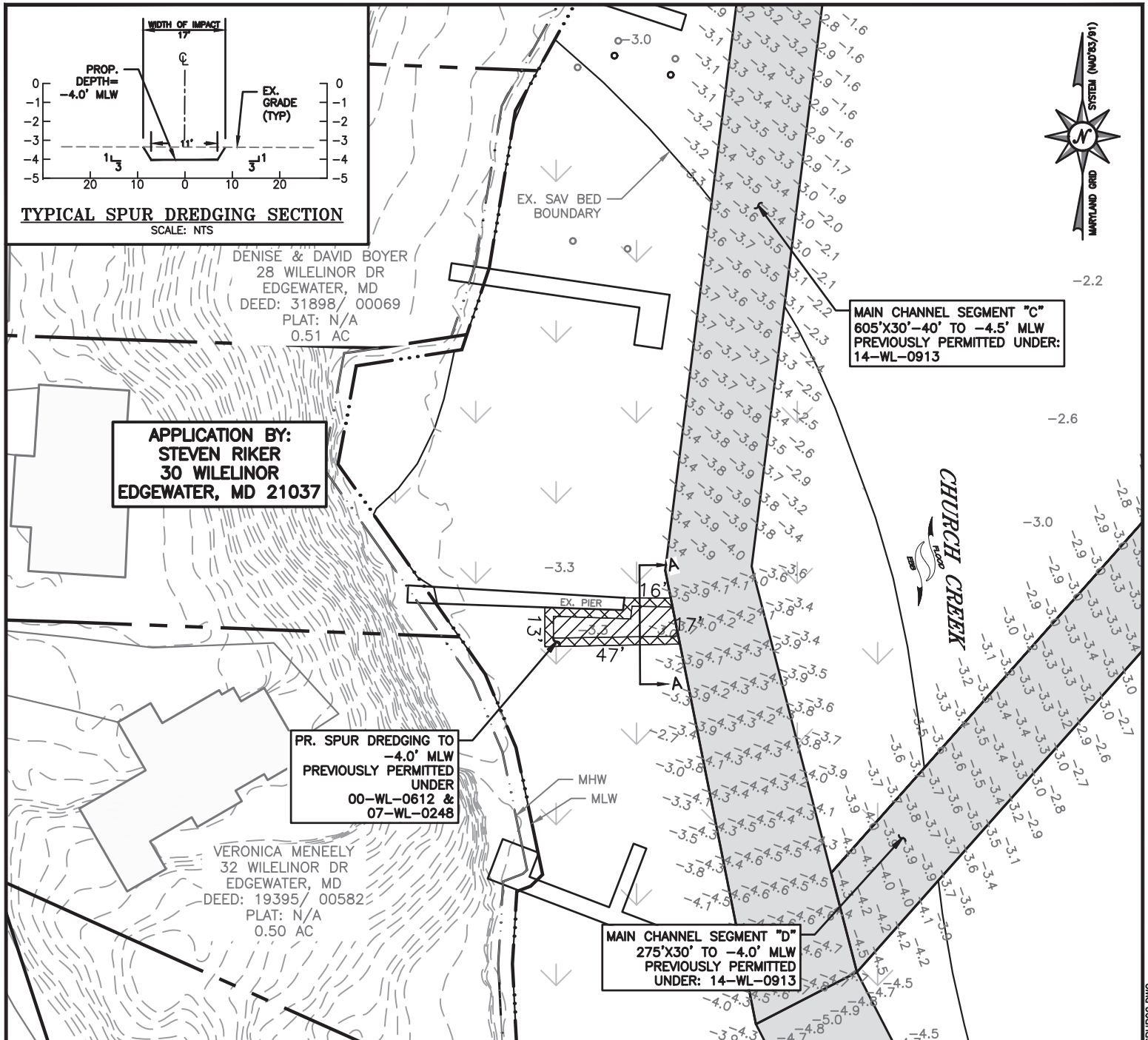

**TYPICAL SPUR DREDGING SECTION**  
SCALE: NTS

**MAIN CHANNEL SEGMENT "C"**  
605'X30' - 40' TO -4.5' MLW  
PREVIOUSLY PERMITTED UNDER:  
14-WL-0913

**APPLICATION BY:**  
**STEVEN RIKER**  
30 WILELINOR  
EDGEWATER, MD 21037

**PR. SPUR DREDGING TO**  
**-4.0' MLW**  
PREVIOUSLY PERMITTED  
UNDER  
00-WL-0612 &  
07-WL-0248

**MAIN CHANNEL SEGMENT "D"**  
275'X30' TO -4.0' MLW  
PREVIOUSLY PERMITTED  
UNDER: 14-WL-0913

**SPUR DATA**

AREA = 660 SF  
VOLUME = 20 CY  
2023 SAV IMPACT = 660 SF

**SAV LEGEND**

COMPOSITE SAV BED FROM SPRING AND SUMMER SAV SURVEY 2023  
SPRING SURVEY DATE: MAY 10, 2023  
SUMMER SURVEY DATES: JULY 20, 2023

**Spur 2**  
**24-WL-0163**  
**Riker**

**LEGEND**

- 1.0 EXISTING DEPTH
- EXISTING PILING
- PROPOSED PILING
- BOTTOM CUT AREA
- SIDE SLOPE AREA

**24-WL-0054**  
**202460070**  
**8/7/2024**  
**Sheet 12 of 18**

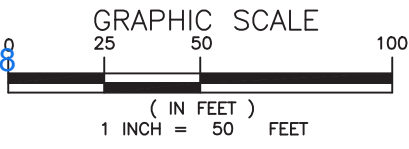

**NOTES:**

1. TIDAL RANGE IS 1.0 FEET.
2. SOUNDINGS ARE IN FEET AND REFER TO MLW.
3. MATERIAL WILL BE PLACED AT ROCK CREEK DMP SITE.
4. THESE ARE PERMIT DRAWINGS ONLY. DESIGN DRAWINGS WILL BE PREPARED SEPARATELY.
5. BASEMAP TAKEN FROM ANNE ARUNDEL COUNTY 2020 PLANIMETRICS AND 2020 IMAGERY.

**Bayland**  
Consultants & Designers, Inc.  
"Integrating Engineering and Environment"  
7455 New Ridge Road, Suite T Phone: (410) 694-9401  
Hanover, Maryland 21076 Fax: (410) 694-9405  
www.baylandinc.com

CHURCH CREEK SPURS  
SPUR 2  
STEVEN RIKER  
30 WILELINOR DRIVE  
EDGEWATER, MD 21037  
MARCH 2024

Z:\5\_4903\_CHURCH\_CREEK\_DREDGING\CAD FILES\SHEET FILES\NPA\SPURS\5\_4903\_RIKER\_SPUR02.DWG

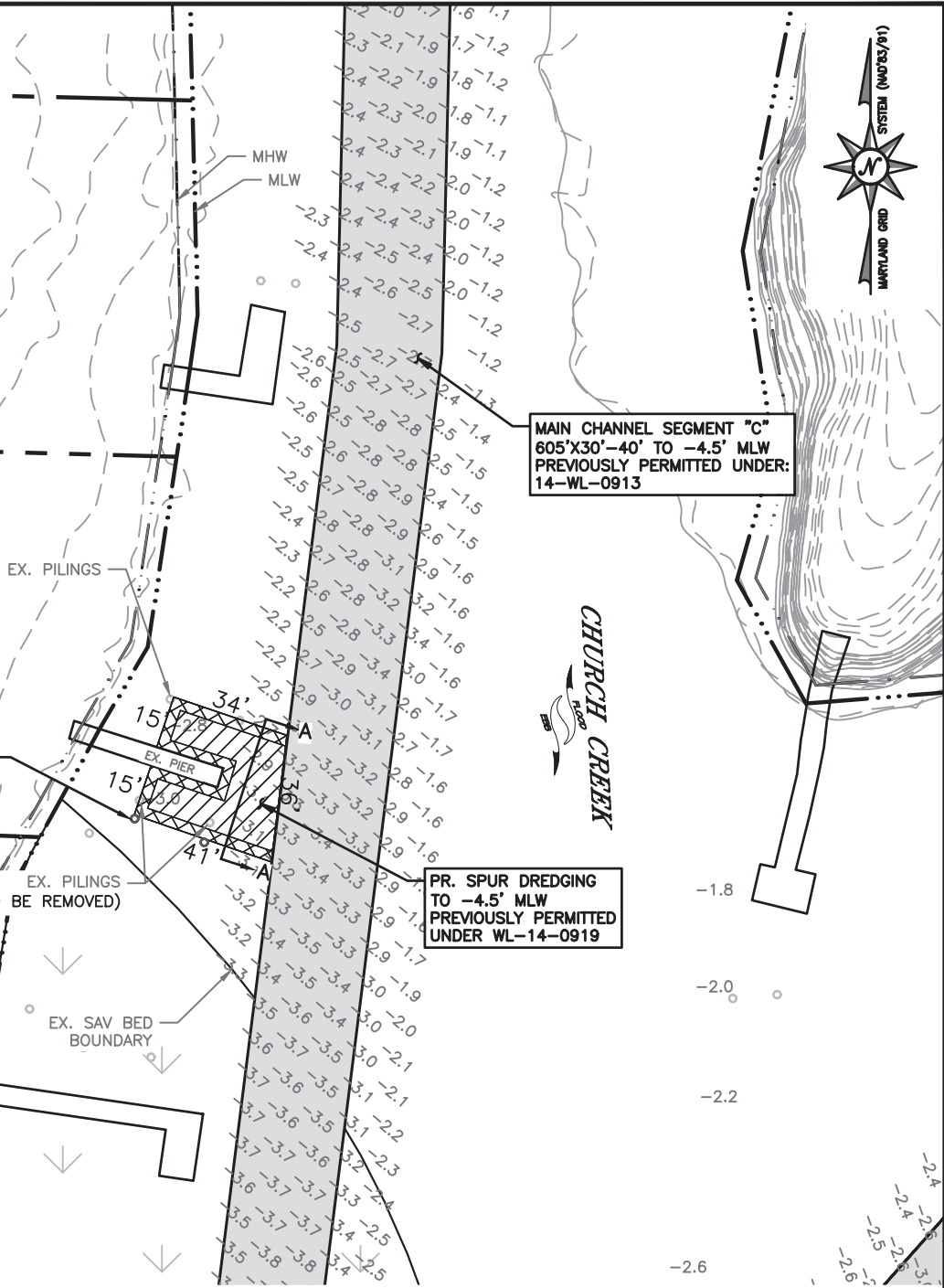
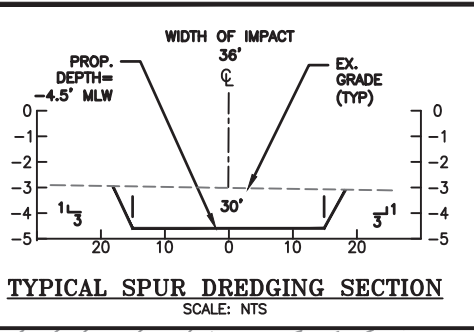

**APPLICATION BY:**  
**DAVID & DENISE BOYER**  
**26 WILELINOR**  
**EDGEWATER, MD 21037**  
**PREVIOUSLY PERMITTED**  
**UNDER WL-14-0919**

DENISE & DAVID BOYER  
 28 WILELINOR DR  
 EDGEWATER, MD  
 DEED: 31898/00069  
 PLAT: N/A  
 0.51 AC

STEVEN RIKER  
 30 WILELINOR DR  
 EDGEWATER, MD  
 DEED: 26929/00186  
 PLAT: N/A  
 0.39 AC

**SPUR DATA**  
 AREA = 1,227 SF  
 VOLUME = 100 CY  
 2023 SAV IMPACT = NONE

**LEGEND**  
 -1.0 EXISTING DEPTH  
 ○ EXISTING PILING  
 ● PROPOSED PILING

**SAV LEGEND**  
 ○ COMPOSITE SAV BED FROM SPRING AND SUMMER SAV SURVEY 2023  
 SPRING SURVEY DATE: MAY 10, 2023  
 SUMMER SURVEY DATES: JULY 20, 2023

▨ BOTTOM CUT AREA  
 ▩ SIDE SLOPE AREA

**24-WL-0054**  
**202460070**  
**8/7/2024**  
**Sheet 13 of 18**

**Spur 1**  
**24-GL-0164**  
**Boyer**

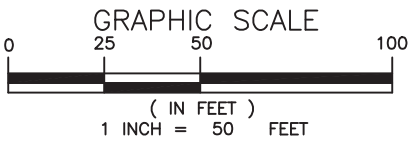

- NOTES:**
1. TIDAL RANGE IS 1.0 FEET.
  2. SOUNDINGS ARE IN FEET AND REFER TO MLW.
  3. MATERIAL WILL BE PLACED AT ROCK CREEK DMP SITE.
  4. THESE ARE PERMIT DRAWINGS ONLY. DESIGN DRAWINGS WILL BE PREPARED SEPARATELY.
  5. BASEMAP TAKEN FROM ANNE ARUNDEL COUNTY 2020 PLANIMETRICS AND 2020 IMAGERY.

**Bayland**  
 Consultants & Designers, Inc.  
 "Integrating Engineering and Environment"  
 7455 New Ridge Road, Suite T Phone: (410) 694-9401  
 Hanover, Maryland 21076 Fax: (410) 694-9405  
 www.baylandinc.com

CHURCH CREEK SPURS  
 SPUR 1  
 DAVID & DENISE BOYER  
 26 WILELINOR DRIVE  
 EDGEWATER, MD 21037  
 MARCH 2024

**APPLICATION BY:**  
**JOHN SMITH & PATRICIA LOGAN**  
**2020 VINEYARD RD**  
**ANNAPOLIS, MD 21401**  
**PREVIOUSLY PERMITTED**  
**UNDER 90-WL-1191**  
**& 88-3177-4**

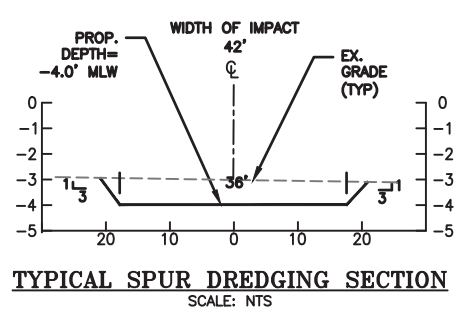

**TYPICAL SPUR DREDGING SECTION**  
 SCALE: NTS

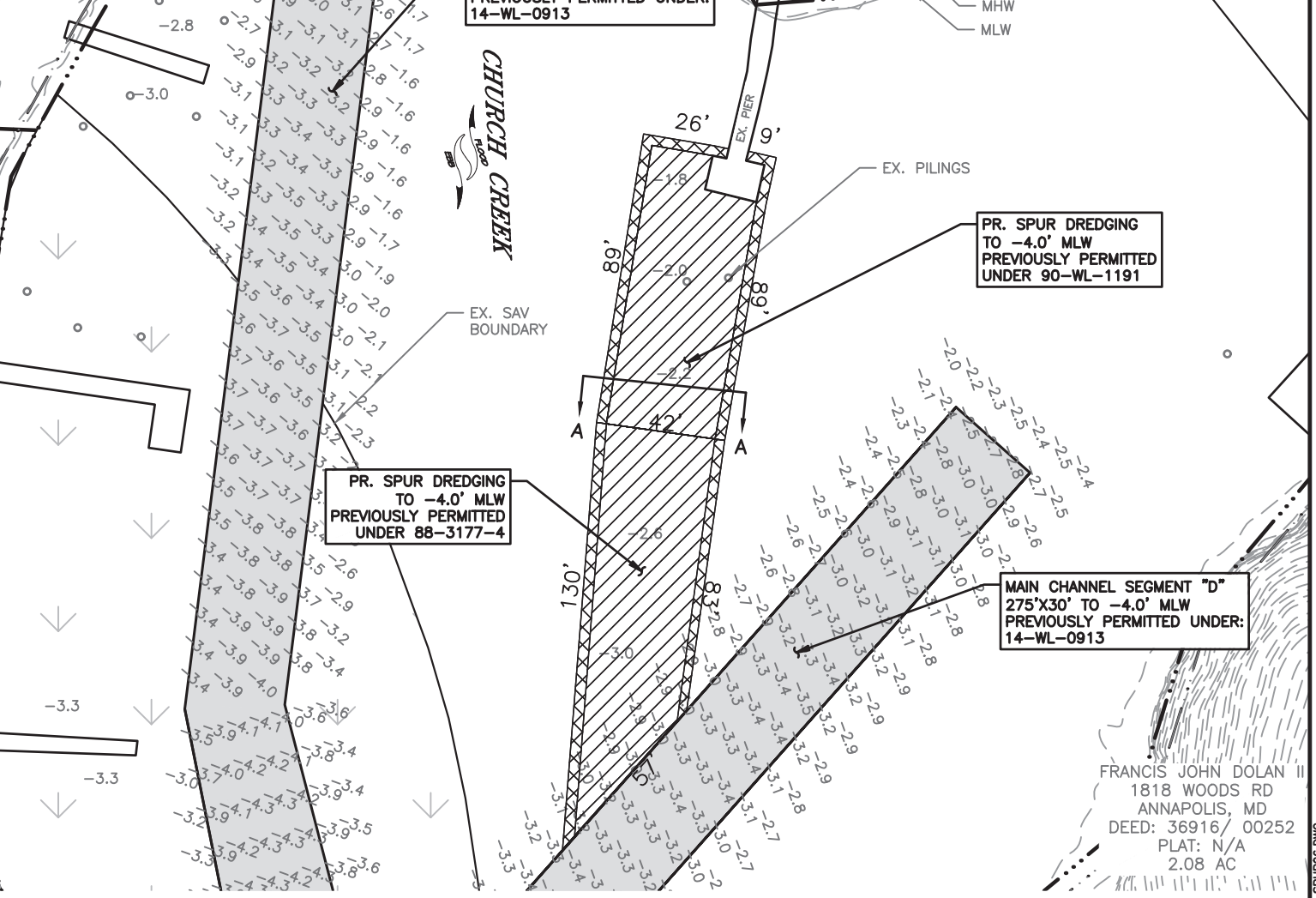

**MAIN CHANNEL SEGMENT "C"**  
**605'x30' -4.5' MLW**  
**PREVIOUSLY PERMITTED UNDER:**  
**14-WL-0913**

**PR. SPUR DREDGING**  
**TO -4.0' MLW**  
**PREVIOUSLY PERMITTED**  
**UNDER 90-WL-1191**

**PR. SPUR DREDGING**  
**TO -4.0' MLW**  
**PREVIOUSLY PERMITTED**  
**UNDER 88-3177-4**

**MAIN CHANNEL SEGMENT "D"**  
**275'x30' TO -4.0' MLW**  
**PREVIOUSLY PERMITTED UNDER:**  
**14-WL-0913**

FRANCIS JOHN DOLAN II  
 1818 WOODS RD  
 ANNAPOLIS, MD  
 DEED: 36916/ 00252  
 PLAT: N/A  
 2.08 AC

**SPUR DATA**

AREA = 7,346 SF  
 VOLUME = 515 CY  
 2023 SAV IMPACT = NONE

**LEGEND**

- 1.0 EXISTING DEPTH
- EXISTING PILING
- PROPOSED PILING

**SAV LEGEND**

COMPOSITE SAV BED FROM SPRING AND SUMMER SAV SURVEY 2023  
 SPRING SURVEY DATE: MAY 10, 2023  
 SUMMER SURVEY DATES: JULY 20, 2023

- BOTTOM CUT AREA
- SIDE SLOPE AREA

24-WL-0054  
 202460070  
 8/7/2024  
 Sheet 14 of 18

Spur 6  
 24-WL-0165  
 Smith

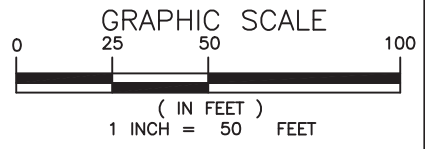

**NOTES:**

1. TIDAL RANGE IS 1.0 FEET.
2. SOUNDINGS ARE IN FEET AND REFER TO MLW.
3. MATERIAL WILL BE PLACED AT ROCK CREEK DMP SITE.
4. THESE ARE PERMIT DRAWINGS ONLY. DESIGN DRAWINGS WILL BE PREPARED SEPARATELY.
5. BASEMAP TAKEN FROM ANNE ARUNDEL COUNTY 2020 PLANIMETRICS AND 2020 IMAGERY.

**Consultants & Designers, Inc.**  
*"Integrating Engineering and Environment"*  
 7455 New Ridge Road, Suite T Phone: (410) 694-9401  
 Hanover, Maryland 21076 Fax: (410) 694-9405  
 www.baylandinc.com

CHURCH CREEK SPURS  
 SPUR 6  
 JOHN SMITH & PATRICIA LOGAN  
 2020 VINEYARD RD  
 ANNAPOLIS, MD 21401  
 MARCH 2024

Z:\5\_4903\_CHURCH\_CREEK\_DREDGING\CAD FILES\SHEET FILES\PA\SPURS\5\_4903\_SMITH\_SPUR06.DWG



MECHANICAL UNLOADING POINT

LIMIT OF CONTAINMENT AREA

EX. PERIMETER DIKE

EX. WEIR BOX AND  
OUTFALL STRUCTURE  
TO BE MAINTAINED

MAINTENANCE DREDGING  
AT  
CHURCH CREEK  
ANNE ARUNDEL COUNTY

24-WL-0054  
202460070  
8/7/2024  
Sheet 15 of 18

APPL. BY: ANNE ARUNDEL COUNTY DEPARTMENT OF PUBLIC WORKS

SOUTH COUNTY DMP SITE

DATE: MARCH 2024

NOTES:  
1. BASEMAP COMPILED FROM ANNE ARUNDEL  
2016 PLANIMETRICS AND 2020 IMAGERY.

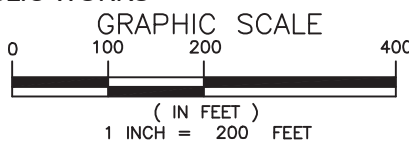

**Bayland**  
Consultants & Designers, Inc.  
"Integrating Engineering and Environment"

7455 New Ridge Road, Suite 1 Phone: (410) 694-9401  
Hanover, Maryland 21076 Fax: (410) 694-9405  
www.baylandinc.com

Z:\5\_4903\_CHURCH\_CREEK\_DREDGING\CAD FILES\SHEET FILES\5\_4903\_SOUTHCOUNTY.DWG

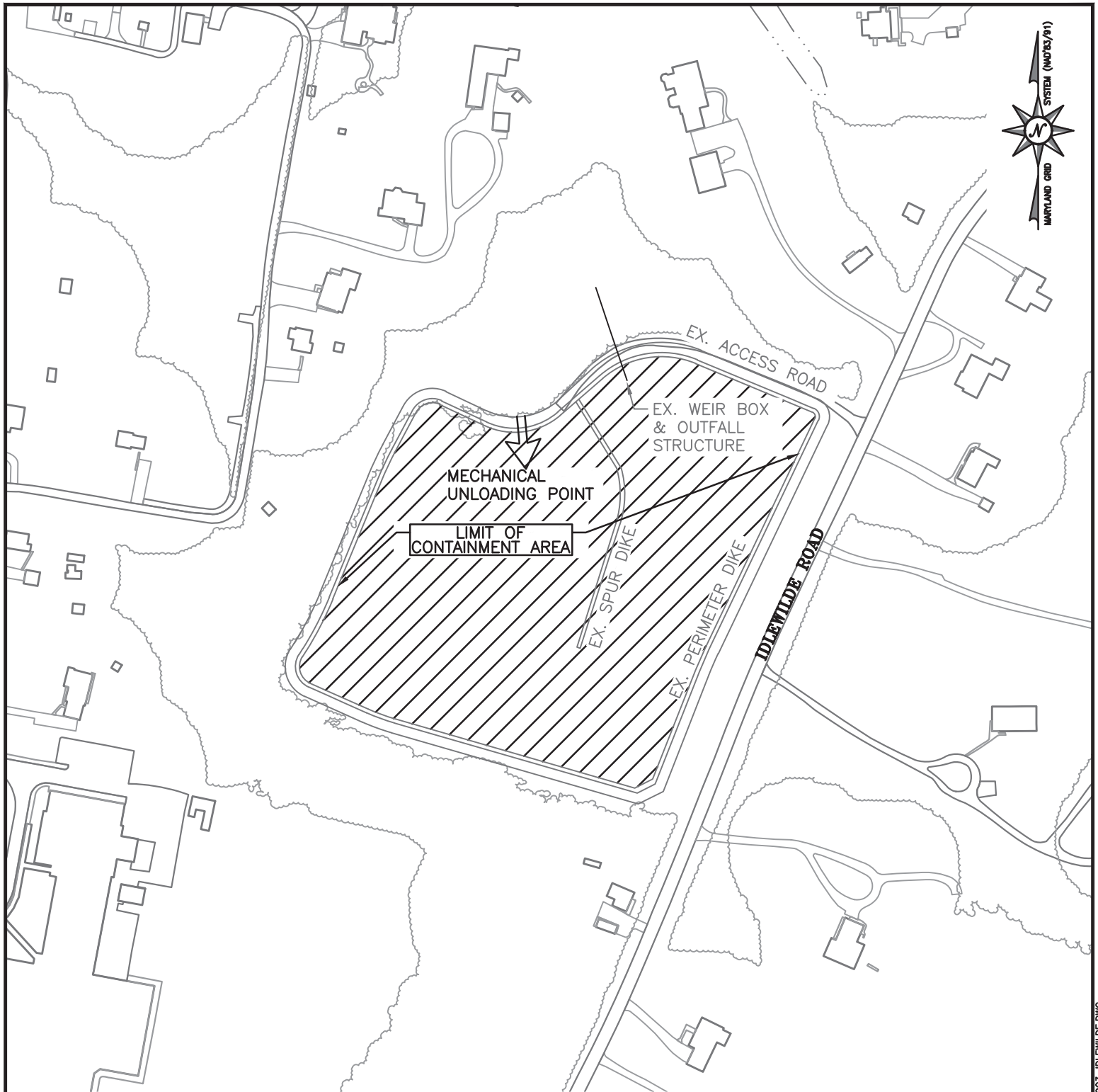

MAINTENANCE DREDGING  
 AT  
 CHURCH CREEK  
 ANNE ARUNDEL COUNTY

24-WL-0054  
 202460070  
 8/7/2024  
 Sheet 16 of 18

APPL. BY: ANNE ARUNDEL COUNTY DEPARTMENT OF PUBLIC WORKS

IDLEWILDE DMP SITE

DATE: MARCH 2024

NOTES:  
 1. BASEMAP COMPILED FROM ANNE ARUNDEL  
 2016 PLANIMETRICS AND 2020 IMAGERY.

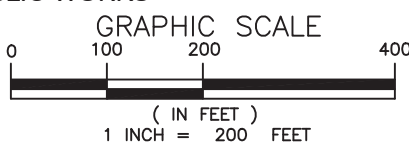

**Bayland**  
 Consultants & Designers, Inc.  
 "Integrating Engineering and Environment"

7455 New Ridge Road, Suite 1 Phone: (410) 694-9401  
 Hanover, Maryland 21076 Fax: (410) 694-9405  
 www.baylandinc.com





WATER OAK POINT ROAD

EX. ACCESS ROAD

EX. EMBANKMENT

EX. WEIR BOX &  
OUTFALL STRUCTURE  
TO BE MAINTAINED

LIMIT OF  
CONTAINMENT AREA

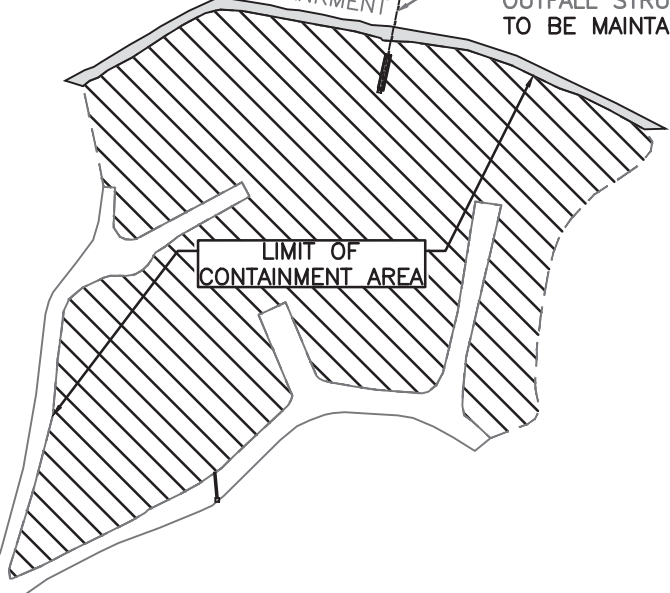

24-WL-0054  
202460070  
8/7/2024  
Sheet 17 of 18

MAINTENANCE DREDGING  
AT  
CHURCH CREEK  
ANNE ARUNDEL COUNTY

APPL. BY: ANNE ARUNDEL COUNTY DEPARTMENT OF PUBLIC WORKS

ROCK CREEK DMP SITE

DATE: MARCH 2024

NOTES:  
1. BASEMAP COMPILED FROM ANNE ARUNDEL  
2016 PLANIMETRICS AND 2020 IMAGERY.

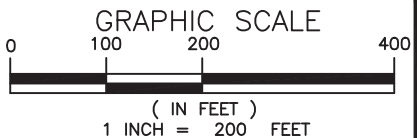

  
Consultants & Designers, Inc.  
"Integrating Engineering and Environment"  
7455 New Ridge Road, Suite 1 Phone: (410) 694-9401  
Hanover, Maryland 21076 Fax: (410) 694-9405  
www.baylandinc.com

Z:\5\_4903\_CHURCH\_CREEK\_DREDGING\CAD FILES\SHEET FILES\5\_4903\_ROCKCREEK.DWG



**Bureau of Engineering**  
Heritage Office Complex  
2662 Riva Road, 3<sup>rd</sup> Floor  
Annapolis, MD 21401  
Phone (410) 222-7500

January 16, 2024

To whom it may concern:

The Rock Creek Dredge Material Placement (DMP) Site located on Water Oak Point Road in Pasadena, Maryland is a previously approved placement site owned and operated by the Anne Arundel County Department of Public Works (DPW). The Rock Creek DMP Site has been scheduled for mechanical dredge material placement from the Church Creek maintenance dredging project. This includes the main channels and all associated spurs.

The current capacity of the Rock Creek DMP Site is approximately 30,000 cubic yards.

Alternate Site #1 – The Idlewilde Dredge Material Placement (DMP) Site located on Idlewilde Road in Shady Side, Maryland is a previously approved placement site owned and operated by the Anne Arundel County Department of Public Works (DPW). The Idlewilde DMP Site has been scheduled as an alternate placement site for mechanical dredge material placement from the Church Creek maintenance dredging project. This includes the main channels and all associated spurs.

The current capacity of the Idlewilde DMP Site is approximately 45,000 cubic yards.

Alternate Site #2 – The South County Dredge Material Placement (DMP) Site located on Sudley Road in West River, Maryland is a previously approved placement site owned and operated by the Anne Arundel County Department of Public Works (DPW). The South County DMP Site has been scheduled as an alternate placement site for mechanical dredge material placement from the Church Creek maintenance dredging project. This includes the main channels and all associated spurs.

The current capacity of the South County DMP Site is approximately 120,000 cubic yards.

Sincerely,

Melissa Harlinski  
Project Manager

24-WL-0054  
202460070  
8/7/2024  
Sheet 18 of 18

cc: File Q584901 (3)  
Chris Rager – BayLand Consultants & Designers, Inc.